

SPECTRUM LS6000



**Operating
Instructions**



Contents

Contents	Page
1 Batteries	3
2 Opening	4
3 Setting User Code	4
4 Locking	5
5 LED Light	5
6 Multi-user mode & Dual-user mode	6
7 Changing Door Panel	7

FOR SAFETY

Prior to using the safe, please read the instructions carefully.

Cautions when placing the safe.

The safe is heavy and should be handled very carefully.

Never move the safe with the door open.

Place the safe on flat floor.

Cautions when using the safe.

Be careful not to slam the door closed.

Be careful not to trap hands or fingers when closing door.

As the safe is heavy and operated with a smart digital lock, it is not recommended that children operate the safe.

Be careful not to forget the user code, and keep the instruction outside of the safe.

Components

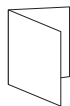

Instructions

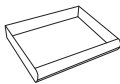

Drawer

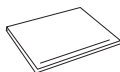

Shelf



Shelf Clips
(4pcs)

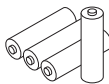

1.5V Alkaline
AA Batteries
(4pcs)

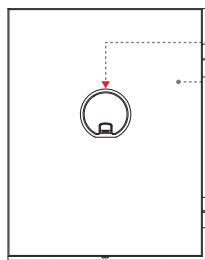

Digital Lock

Door Panel

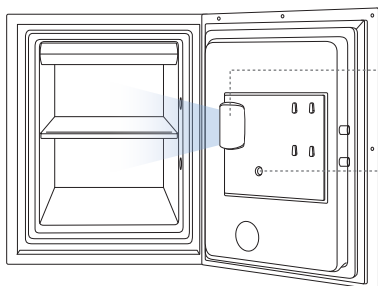

LEDLight

Ⓜ Memory Button

1. Batteries

Prior to using safe, install 4pcs of AA alkaline batteries.

(LED flickers, Bi Bi Bi sound, Melody rings for 1 second)

* Non-alkaline and rechargeable batteries are not recommended.

The batteries need to be replaced when 'Bi-ric' sound is emitted when any button is pressed.

Replace all 4 batteries at the same time.

* Battery life span : 1 year (Average openings 3 times a day)

* When the batteries are replaced, the registered user code is not erased.

* **Note:** If the door does not open in spite of the correct user code being entered, please change the batteries before calling for service.

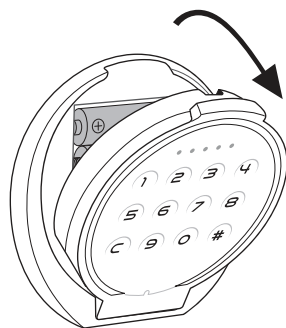

2. Opening

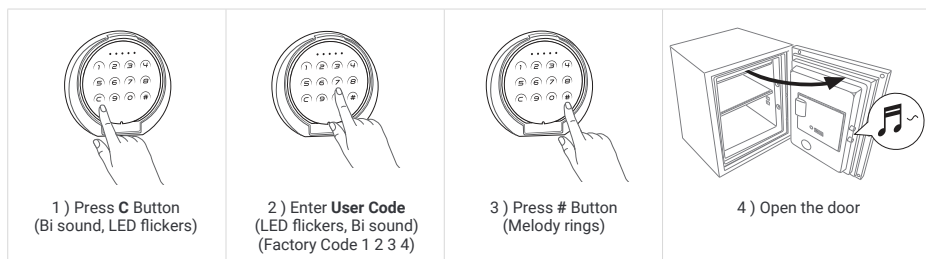

NOTE: If wrong code is tried, Red LED flickers sounding Bi Bi Bi Bi.

Paralysis: If a wrong code is entered 5 times, the lock will be paralyzed for 5 minutes

Remaining paralysis time can be checked via the LED.

Eg) In the case of 4 minutes remaining, LED flickers 4 times every 10 seconds.

Scramble Numbers: The code can be disguised by inserting random numbers either before, after or both before and after the user code. E.g. user code of 1234, xxx1234, 1234xxx or xxx1234xxx. Total of 32 numbers can be accepted.

Mute sound: You can hide the button sound.

SET: M → 7 → # 

UNSET: M → # → 7 → # 

3. Set User Code

Keep the door open.

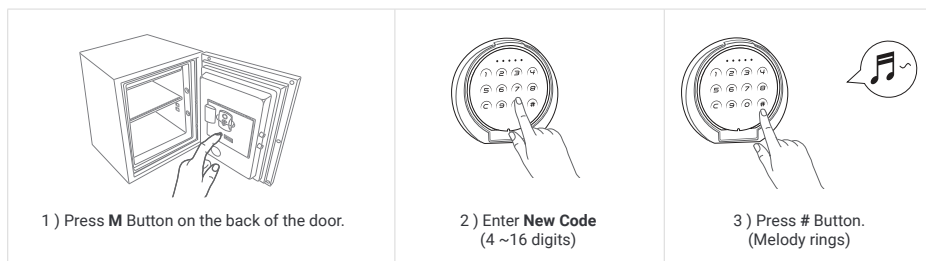

NOTE: 1) Prior to closing the door, check the new code has been registered correctly by following **2. Opening**.

2) It is not recommended to use codes such as a telephone numbers, birthday or consecutive numbers for security reasons.

4. Locking

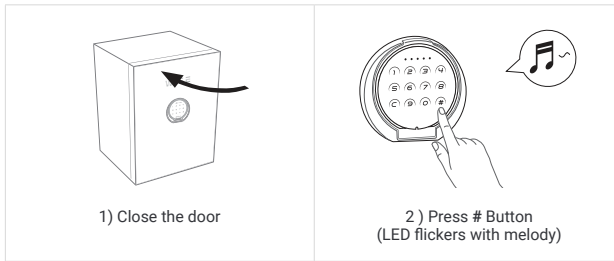

NOTE:

- 1) Don't close the door with the bolts in the locked position.
- 2) If door is unlocked when # button pressed, red LED turns on sounding Bi Bi Bi Bi.
- Door may not be closed because of over inside matters.

Door open alert: If the door is not locked within 1 minute after opening, an alert will sound for 30 seconds.

5. LED Light



LED turns on for 15 seconds, each time the **C** button is pressed.

6. Multi-user mode & Dual-user mode

Multi-user mode: Two users can independently open the safe with their own user code.

Dual-user mode: Two different codes should be entered consecutively to open the safe.

* Both modes can not be used simultaneously.

Multi-user mode

SET: M → 2 → # → 2nd Code → # 

- NOTE:**
- 1) Prior to closing the door, confirm the 2nd code has been registered correctly by following **2. Opening**
 - 2) 2nd code can be changed in the same way as **Multi-user mode > set** .
 - 3) For setting or changing 1st code, please do as shown in **3. Setting User Code** .

UNSET: M → # → 2 → # 

NOTE: When unsetting multi user codes the 2nd code is removed automatically. The 1st code will be retained.

OPEN: C → 1st Code or 2nd Code → #  → Open the door

Dual-user mode

SET: M → 9 → # → 2nd Code → # 

- NOTE:**
- 1) Prior to closing the door, confirm the fingerprint has been registered correctly as shown in **2. Opening**
 - 2) 2nd code can be changed in the same way as the initial set up **Dual-user mode > SET**
 - 3) For setting or changing the 1st code, please follow the instructions in **3. Set User Code**.

UNSET: M → # → 9 → # 

NOTE: When unsetting dual mode, the 2nd code is removed automatically. The 1st code will be retained.

OPEN: C → 1st Code → # → 2nd Code → #  → Open the door

7. Changing Door Panel

When changing the panel please take care not to trap fingers in between the panel and door frame. It is recommended when replacing the panel with a new one, to wear gloves.

ATTACH PANEL

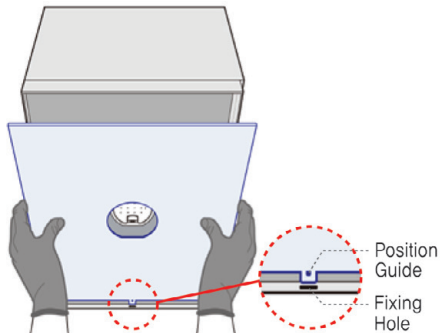

1) Hold and adjust the panel to allow the position guide to locate into the fixing hole.

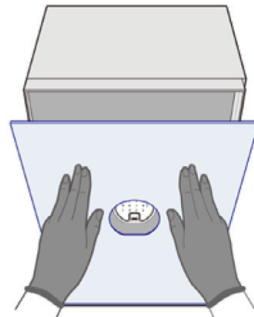

2) Push the panel into the door frame to attach.

DETACH PANEL

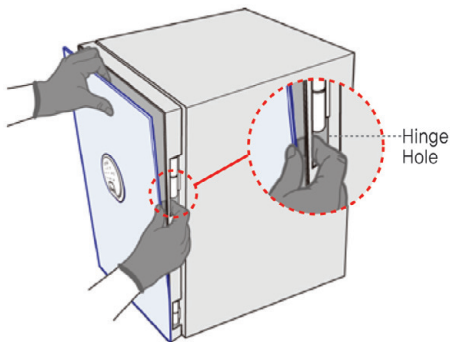

1) Place a finger into the hinge hole on upper right side of door frame and push the panel outwards to detach.

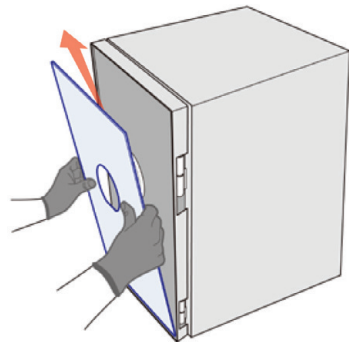

2) Lift the panel up to detach.

Need support?

We're here if you need us.

Web	www.phoenixsafe.co.uk
Email	info@phoenixsafe.co.uk
Phone	0151 944 6444

**Where peace of mind
is guaranteed.**

